

Flag sign QF

For immediate location of important spots in vast building complexes.

Flag sign QF

Mounting stability without visible screws and wall flanges.

Σ quintessenz

Σ quintessenz



Flag signs are wall mounted elements that can be used on both sides. They allow elevators, staircases, toilets and registrations to be found quickly, especially in corridors or long buildings.

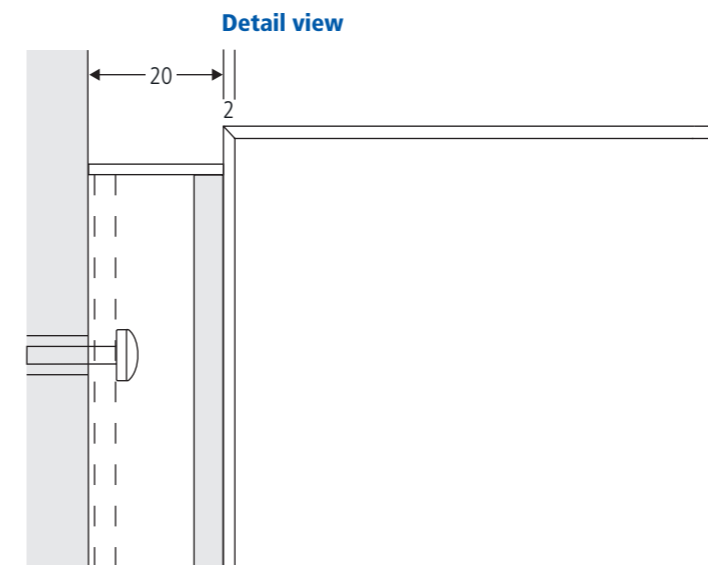
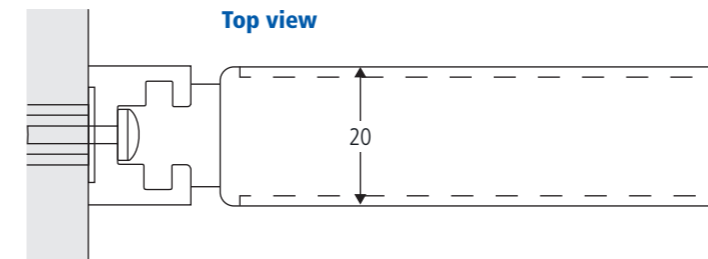

Standard sizes
Specifications in mm

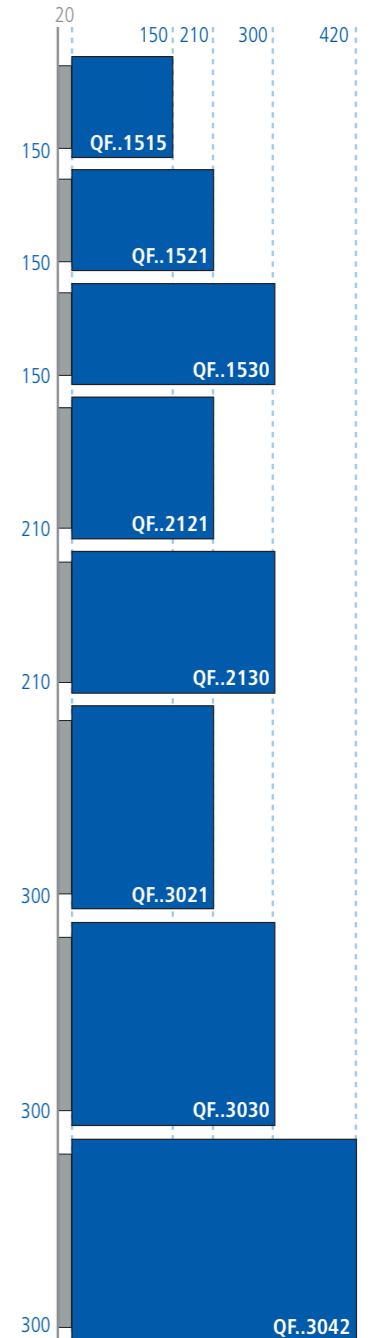

quintessenz flag signs

can always be written on both sides. They can be mounted as wall or directly attached ceiling flags. Production programs are stored for the standard dimensions. Individual dimensions are possible: long, narrow cantilevers are, however, subject to great leverage; they

should be avoided for reasons of stability, especially on lightweight walls.

Outdoor applications

must be designed on request due to wind forces and for larger designs with internal frames.

Also possible as direct ceiling mounting



Article designations	Variants	Size
QFA 1530	QFA 1530	QFA 1530
QF stands for quintessenz Flag sign	QFA Aluminium hollow panels with painted or anodized surfaces	15 Height in cm
	QFAI with integrated anti-buckling protection	30 Width in cm
	QFV variable by changing the text inserts (anti-reflex acrylic)	(The dimensions in the article numbers only indicate rounded dimensions of the visible surfaces)
	QFE with visible surface of brushed stainless steel	